



rec'd
12/19/16
copy to planning
pls.

December 14, 2016

RE: Yoder Gravel Pit - Jake Yoder, Operator - Opencut #2863
Stevensville, Ravalli County, Montana
Public Notice for Montana Department of Environmental Quality – Opencut Mining Program

To Whom It May Concern:

Jake Yoder plans to begin work in a new opencut gravel pit at 4376 Eastside Highway, legally described as Parcel B2 of CS 700528-R in the NE¼, SE¼, and NW¼ of Section 24, T09N, R20W, in Stevensville, Ravalli County, Montana. The gravel pit operation will occupy a total of 13.1 acres of land owned by Jake Yoder. It is planned to remove approximately 90,000 cubic yards of material over a period of approximately twenty-five years that will be processed and used for construction. A Montana Department of Environmental Quality (MDEQ) Opencut Mining permit has been applied for. As a part of the permit application process, the operator is required to send a public notice to all property owners located within one-half mile of the proposed boundary of the opencut permit, as well as publish notice of the proposed site twice in a local newspaper and in the proximity of the site.

Currently, the site is open rangeland. The site contains 10-inches of topsoil that will be stockpiled and replaced once mining operations have concluded on the site. Gravels are the materials that will be mined from the site using facilities/equipment such as a crusher, screen(s), grizzly, backhoe, dozer, dump truck, excavator, loader, scraper, skidsteer, and other equipment to mine the site. The site is accessed by starting in Stevensville, MT at the intersection of Main Street and Eastside Highway. Head east on the Eastside Highway and continue where it turns north for approximately 1 mile. The site is currently open rangeland with no access, but one will be constructed once the site is permitted. The attached site map shows the proposed gravel pit operations. Also included with this letter is the MDEQ *Request for Public Meeting* form, which provides information on how surface landowners can request a public meeting to discuss this operation, if desired. The current opencut permitting activities, including reclamation, are planned to be completed by December, 2042. If you have any questions, please contact the operator at the information below.

Operator Contact Information

Jake Yoder, Owner/Operator
964 Stevensville Airport Road
Stevensville, MT 59870
Phone Number: (406) 274-8348

Sincerely,
Territorial-Landworks, Inc.

Andrew Mill, E.I.

Enclosures: Site Map
MDEQ Request for Public Meeting Form

C. Jake Yoder, Owner – 964 Stevensville Airport Rd, Stevensville, MT 59870 (w/ enclosures)
File & Scan (w/ enclosures)

T:\1_ACTIVE FILES\2016 Projects\4249 - Jake Yoder Stevensville Gravel Pit\5_CONSTRUCTION\5.1_Construction Permits\5.1.1_Opencut Mining Permit\2016-11-21.Original Submittal Documents\Public Notice\Public Notice - Landowners - Yoder Gravel Pit 2016-10-XX.doc

REQUEST FOR PUBLIC MEETING

The Department of Environmental Quality (DEQ) is accepting requests for a public meeting on the following proposed opencut operation in your area:

DEQ SECTION

Operator: Jake Yoder Site: Yoder Gravel Pit County: Ravalli Opencut #: 2863

Legal Description: Section 24, Township 9 N, Range 20 W

Public Meeting Request Period: The DEQ will accept requests for a public meeting until January 22, 2017.

SURFACE LANDOWNER SECTION

1. When determining the number of surface landowners eligible to request a public meeting:
 - a. Multiple parties owning the same parcel of land are counted as 1 landowner.
 - b. A party owning multiple parcels of land is counted as 1 landowner, regardless of the number of parcels owned.
2. If you wish to request a public meeting, complete the following and submit to:
DEQ Opencut Mining Program, PO Box 200901, Helena, MT 59620-0901; Fax: (406) 444-4988;
Email: DEQOpencut@mt.gov

☐ YES or ☐ NO (Check one) I request that DEQ conduct a public meeting about this proposed opencut operation.

Landowner: Name (print or type) _____

Address _____

Email _____

City, State, Zip _____

Signature _____

Date _____

Phone Number _____

NOTE: Landowners can also submit written comments about the proposed operation to the DEQ using the contact information listed below.

The following information applies to requests for a public meeting:

- A copy of the application for the proposed operation can be viewed at <http://SearchOpencutPermits.mt.gov>. If additional information about the proposed operation is needed, please contact the operator at the address or phone number listed in the public notice provided to you by the operator.
- In accordance with MCA 82-4-432[9], the DEQ must hold a public meeting in the area of the proposed operation if requested by the applicant, or at least 30% of the property owners or 10 property owners, whichever is greater.
- Prior to holding a public meeting, DEQ will send notice of the meeting by first-class mail to surface owners of land located within one-half mile of the boundary of the proposed permit area.
- The public meeting will be held within 30 days of the closing date of the public meeting request period indicated above.

For DEQ use only:

The landowner is on the list provided with the application pursuant to MCA 82-4-432[2](e). ☐ YES ☐ NO

The landowner is on the list provided for the public notice pursuant to MCA 82-4-432[6](d). ☐ YES ☐ NO

The landowner has previously submitted a *Request For Public Meeting* form. ☐ YES ☐ NO

Initials _____ Date _____

LEGEND

- (P) PROPOSED PERMIT BOUNDARY
- (P) 1000' BUFFER FROM PERMIT BOUNDARY
- X PERMIT BOUNDARY COORDINATES
- STOCKPILE AREA
- ▲ X SOIL TEST PIT
- ⊙ (E) WELL
- (P) ACCESS ROAD
- (P) 10' VEGETATIVE BUFFER STRIP

KEYED NOTES

- 1 MINE MATERIAL STOCKPILE AREA (EXISTING AND/OR PROPOSED)
- 2 OVERBURDEN / SOIL STOCKPILE AREA (EXISTING AND/OR PROPOSED)
- 3 PROPOSED GRAVEL ACCESS ROAD FROM EASTSIDE HIGHWAY TO PERMIT AREA (SHOWN AS ±2000' LONG X 20' WIDE) - NOT PERMITTED AND WILL REMAIN AT FINAL RECLAMATION
- 4 APPROXIMATE CENTER OF PERMIT AREA
- 5 LOCATION OF CRUSHER OPERATIONS, EQUIPMENT, STAGING AREA, PARKING AREA, FUELING AREA, AND OTHER PROCESSING EQUIPMENT
- 6 THE STEVENSVILLE AIRPORT IS ON A TERRACE TOP, APPROXIMATELY 100 VERTICAL FEET ABOVE THE OPENCUT SITE AND OUT OF SIGHT

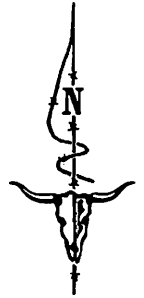

100 0 100 200
SCALE IN FEET

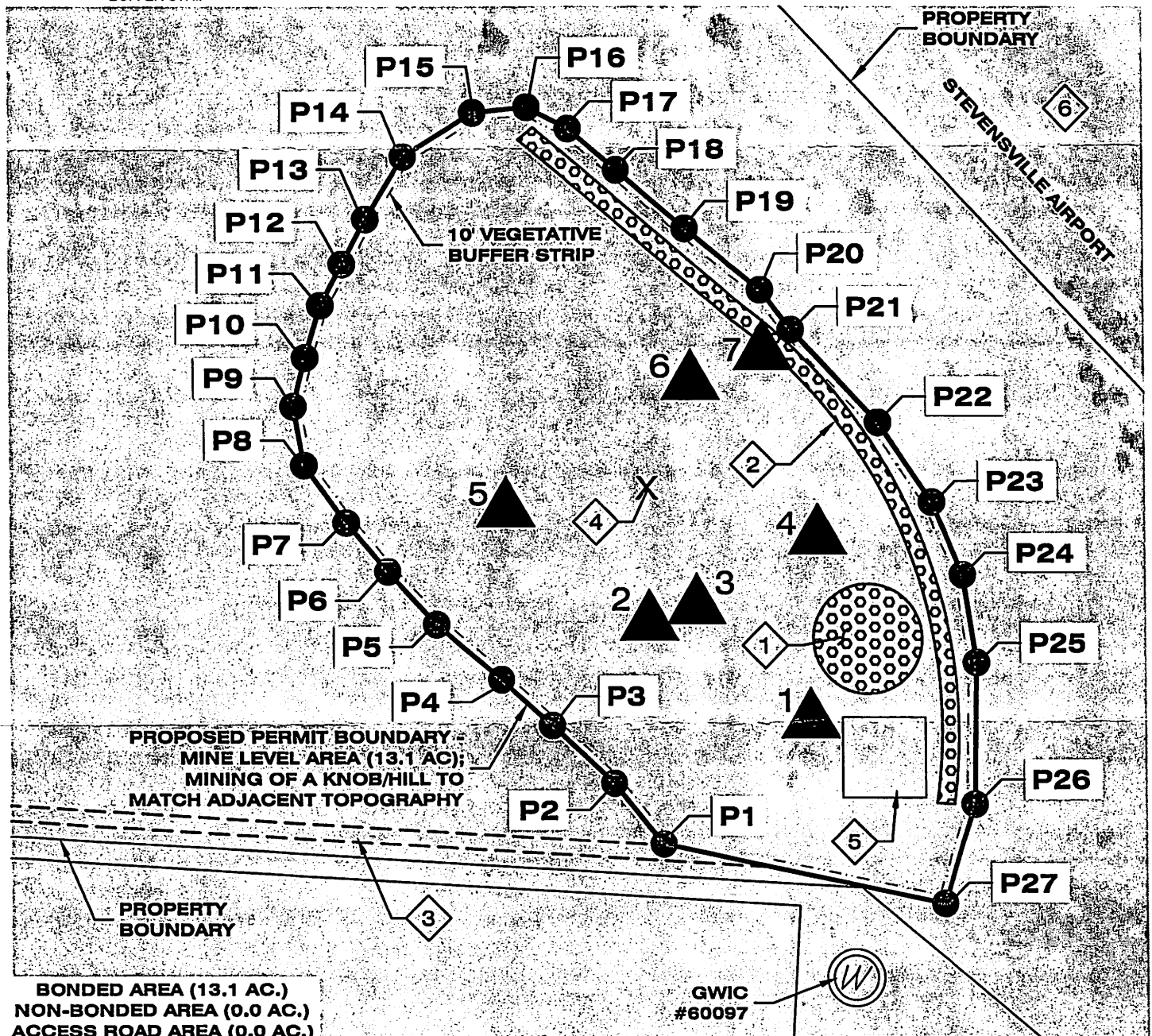

TERRITORIAL LANDWORKS, INC.

CIVIL ENGINEERING • SURVEYING • LAND USE CONSULTING

Ph: 406/721-0142

www.TerritorialLandworks.com

P.O. Box 3851

Fax: 406/721-5224

Missoula, MT 59806

SITE MAP - YODER GRAVEL PIT
JAKE YODER
PARCEL B2 OF C.O.S. 700528-R
SEC. 24, T09N, R20W, P.M.M.
RAVALLI COUNTY, MONTANA

PROJECT#: 16-4249

TAB: SITE MAP

DRAFTER: AM

DATE: 10/17/2016

SHEET 1 OF 1